

PV mounting system MSP-PR Inlay for pitched roofs from Schweizer:

The MSP-PR Inlay photovoltaic mounting system is the innovative insertion system for framed PV modules on pitched roofs. The gentle mounting technique reduces temperature-related stress on the modules and thus increases the service life of the entire PV installation.

MSP-PR Inlay has been optimised for the construction of PV installation on pitched roofs using framed PV modules. The modules can be anchored using either the standard aluminium roof hooks or hanger bolts. Installation is simplest using the MSP-PR aluminium roof hook. Only pre-assembled parts are used, and only two Torx bits are required for installation. For optimal utilisation of space on

the roof, the PV modules can be mounted differently for each row – either horizontally or vertically.

The visible parts of the system are available either in raw aluminium or painted black (RAL 9005). The high quality of the materials and components guarantees a long service life.



PV mounting system MSP-PR Inlay for pitched roofs from Schweizer: for minimum mechanical load on PV modules.

Application

With the MSP-PR Inlay mounting system, the PV modules are not clamped, but instead are inserted and fixed in place in a mounting profile. This means that the PV modules are not stressed by temperature-related expansion.

Flexible and compatible with MSP-PR

The PV mounting system can be anchored with hanger bolts or adjustable aluminium system roof hooks. The vertical profiles are connected in the compatible MSP-PR system. The insert profiles are then mounted horizontally on the vertical profiles in a cross-connection.

Technical Data

- Anchorings: Hanger bolt or aluminium system roof hook, adjustable in height
- Tools: Torx 30 and Torx 40
- Connection channel: Click connector
- Insert profile: for 35 mm and 40 mm module frames
- Rail connector: tool-free assembly, without screws
- Cross connector: MSP-PR system
- Module locks: Wedges for low roof slope and end locks
- Materials: Aluminium, plain stainless steel (A2/A4)
- Visible components available painted black
- High load-bearing capacity against wind and snow loads
- Max. compressive load 2.3 kN per aluminium roof hook
- Max. unseparated profile length: 12.6 m

Plan quickly and easily

- The Solar.Pro.Tool by Schweizer provides detailed documentation of the static calculations, bills of materials and drawings for a fast and safe installation. In addition, the complete 3D visualisation provided by Schweizer's Solar.Pro.Tool enables simple and fast layout planning and optimum use of the roof.

Advantages at a glance

- Insertion system for minimum mechanical stress on PV modules
- Compatible with the MSP-PR photovoltaic mounting system by Schweizer
- Flexible anchoring with hange bolts and aluminium or stainless steel roof hooks
- For photovoltaic modules with frame heights of 35 mm or 40 mm
- Modules can be used in mixed orientation by row
- Black painted version (RAL 9005 deep matt) also available

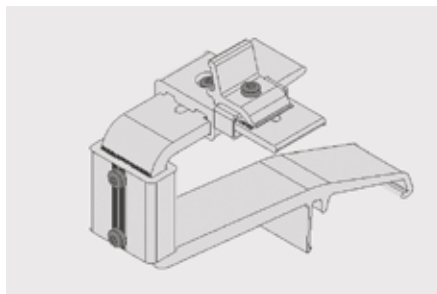

2-part aluminium roof hook, with two base plates and spacer plates as well as adjustable arm

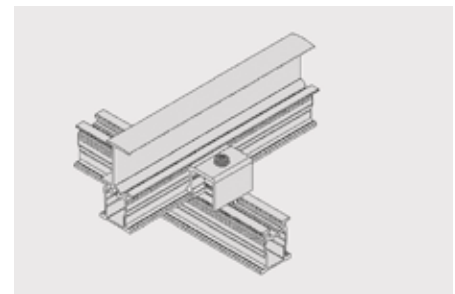

Vertical profile cross connection with insertion profile using MSP-PR cross connector

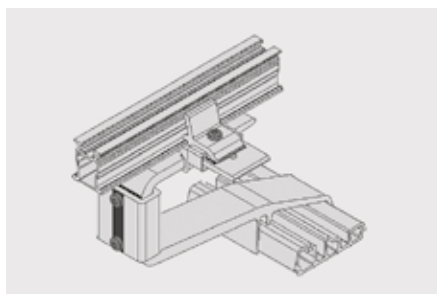

Vertical profile connection with pre-assembled clamp

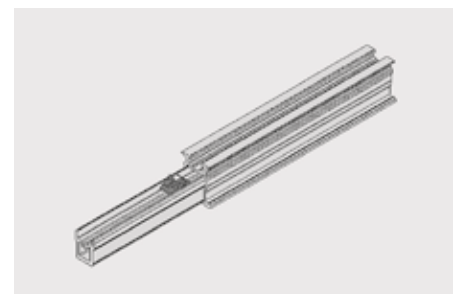

Rail connector without tools for the vertical and insertion profiles